



ELK GROVE Villager

NOVEMBER 2017 ISSUE



IN THIS ISSUE:

- Holiday Tree Lighting
- Leaf Disposal Locations
- Holiday Lights Recycling
- Beware Offers from Electric Suppliers
- Door to Door Solicitors
- Understanding Property Tax Rates
- Trouble With Skunks
- Get to Know Your Property Lines
- Winter Snow & Ice Control
- Don't Veer for Deer
- Signage not Permitted on Public Property

This newsletter is published by the Village of Elk Grove Village, 901 Wellington Avenue, Elk Grove Village, IL 60007. Telephone 847.439.3900, TDD 847.357.4088. www.elkgrove.org

The Village Hall is open 8:30 a.m. to 5:00 p.m. Monday through Friday for payment of water bills, local fines, vehicle stickers and general Village information. In addition, the Finance counter is open on the first Saturday of each month from 9:00 a.m. to noon, and the Community Development counter is open on the first Saturday of the month of May through September from 9:00 a.m. to noon.

Village Board meetings are generally held on the second and fourth Tuesday of the month at 7:00 p.m.

NANCI VANDERWEEL HONORED WITH PLAQUE IN VILLAGE HALL

On September 12, 2017, Nanci Vanderweel was honored with a plaque on the Village's Rotunda of Recognition with sincere gratitude and appreciation of her 47 years of dedicated volunteer service to the Village of Elk Grove.



Nanci Vanderweel served as the first female Village Trustee, among many other firsts. She is a deeply respected community leader who inspired future generations of women and men alike in Elk Grove Village.

Nanci has shown her extraordinary commitment to the community by serving not only as an elected official, but also as a dedicated volunteer. Among her many contributions and posts, Nanci was the originator of the Community Blood Program; served on the Board of Directors of Alexian Brothers Medical Center; Unit Chairwoman of the Salvation Army; and Chairperson of the Cook County Public Aid Committee.

Nanci embodies the spirit of civic engagement and volunteerism. We will be forever grateful for her selfless contributions and her inspiring leadership to guide Elk Grove Village into becoming a truly Exceptional Community.

ELK GROVE 2025 INTERACTIVE PROJECT MAP

Earlier this year, the Mayor and Board of Trustees established Elk Grove 2025 to meet Elk Grove Village's needs today and well into our future. This decision continues the Board's commitment to investing to ensure the community thrives for decades to come. Elk Grove 2025 is a long-range capital plan, which includes public facility improvements, road improvements, streetscaping, bicycle/pedestrian projects, and drainage projects.

The Village has created an interactive map as a tool for residents to learn more about the schedule, location, and details of capital projects planned as part of Elk Grove 2025. The map is available on the Village website at www.elkgrove.org/2025.

MESSAGE FROM THE BOARD

As we approach the end of the year and reflect back on 2017, it is difficult to believe how much has happened in the Village in so short a time. We're proud to say it has been another successful year for our community!

Elk Grove 2025, the Village's long-range capital program is off to a lightning fast start, with construction almost complete for the Biesterfeld Public Works Facility, preparation work underway for the new James Paul Petri Public Works Facility, and designs being completed for two new fire stations in the Village. There is much more to Elk Grove 2025 than facility improvements, however. We're excited to be able to share a new online tool for exploring the many projects included in the capital program. See Page 1 to find out how you can review planned projects and keep track of construction progress on an interactive online map.

Please note that due to ongoing construction, there has been a change to the locations for leaf disposal for residents who still have leaves after their final collection date. This year, the leaf disposal on the west side of the Village will be at Fire Station #10 at 676 Meacham Road. You can find out more about the rules for leaf disposal and drop-off dates on Page 3.

This has also been another amazing year for special events. Residents and guests enjoyed the Village's second annual Oktoberfest on September 29 & 30. This event was popular as part of the Village's 60th Anniversary celebrations in 2016, and we were glad to have the opportunity to make it even better this year, with a new layout and shorter lines! A huge thank you goes out to the Elk Grove Rotary Club, who helped run the event, and also to the volunteers from the Elk Grove VFW. Mark your calendars for next year's Oktoberfest on September 21 & 22, 2018!

The annual Holiday Tree Lighting on Friday, November 24 will conclude this year's event season. We hope you and your family can make it to enjoy a special holiday concert by Gary Lewis & the Playboys, as well as a visit from Santa and a spectacular fireworks display. More information is available on Page 3.

There are currently several door-to-door solicitors



Pictured in front row from left to right are Trustee Christine Prochno, Mayor Craig Johnson, and Trustee Nancy Czarnik. Pictured in the second row from left to right are Trustee Jeffrey Franke, Trustee James Petri, Trustee Samuel Lissner, and Trustee Patton Feichter.

registered with the Village from energy supply companies. Residents are encouraged to make informed decisions about their energy supplier, and never to feel pressured into making a decision on the spot. Information on the Village's solicitor registration process, as well as tips on evaluating offers from electric supply companies are available on Page 4.

We have received a number of questions from residents trying to understand recent increases to their property tax bills and what that means. The Village has worked hard to keep its property tax levy stable and reduce the tax burden on its residents and businesses, so we understand your frustration when the dollar amount of your property tax bill goes up. The 2016 property tax levy (taxes payable in 2017) approved by the Village Board includes a slight decrease to the general fund levy. To better understand how tax rates can change even when a levy stays the same, check out the article on Page 5.

As always, residents are invited to share thoughts, concerns, or questions by clicking "Contact Us" on the Village website (www.elkgrove.org).



20TH ANNUAL HOLIDAY TREE LIGHTING FEATURING GARY LEWIS & THE PLAYBOYS

FRIDAY, NOVEMBER 24, 2017

4:30 P.M. CONCERT; 5:30 P.M. TREE LIGHTING

Join us to welcome the Holiday Season at our annual Holiday Tree Lighting Ceremony! As a special treat, this year's ceremony will feature a special holiday performance by Gary Lewis & the Playboys.

Following the performance, Gary Lewis & the Playboys will join Mayor Johnson in throwing the switch to light up the holiday tree and turn on over 250,000 lights around the Municipal Complex, Library, and Park District.

A special fireworks display will follow the tree lighting, announcing the entrance of Santa and his elves. Hot chocolate, coffee and cookies will be provided.



LEAF DISPOSAL LOCATIONS

The Village would like to thank residents for their participation in the 2017 Fall Leaf Collection program. The final round of leaf pick up begins on November 13 and ends on November 22. For residents who still have leaves, after their final collection date, the Village offers you the ability to dispose of them in dumpsters placed at two convenient locations:



James P. Petri Public Works Facility
600 Landmeier Road
November 13 - December 8



Fire Station 10 Parking Lot
676 Meacham Road
November 20 - December 8



Leaves should be placed in a yard waste collection bag, a landscape waste sticker is NOT required. Please note that plastic bags are not allowed. The dumpsters are for leaves only, yard waste is not permitted. Should you have any questions or experience any problems with the program, please call the Public Works Department at 847-734-8800 Monday through Friday between 8:00 a.m. and 4:30 p.m.

HOLIDAY LIGHTS RECYCLING

The Village is accepting unused and non-working holiday string lights and extension cords as part of the SWANCC Holiday Lights Recycling Program. SWANCC and participating communities have partnered with Elgin Recycling Inc. to recycle the lights and cords.



Community Development Counter
Village Hall, 901 Wellington Ave.
Monday - Friday, 8:30 a.m. - 5:00 p.m.

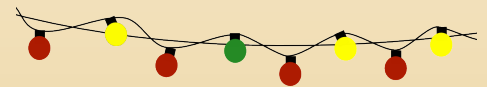

Residents can drop off holiday lights and extension cords now thru March 31, 2017. The Village cannot accept garland, live greens, wreaths, or other non-recyclable materials. Call 847-357-4220 for more information.

BEWARE OFFERS FROM ELECTRIC SUPPLIERS

In Illinois, there are at least 96 alternative retail electric suppliers (ARES) authorized to sell electricity in Illinois. Data shows their customers are paying higher prices than customers with traditional utilities such as ComEd. According to the Illinois Commerce Commission, ARES customers in the ComEd territory as a whole have paid more than \$152 million more for electricity than traditional utility customers from June 1, 2016 through May 31, 2017.

The Illinois Attorney General urges residents to do the following before signing on with an ARES:

- Do not share your utility bill to someone who comes to your door. A marketer must ask for written authorization to access your meter usage.
- Request all marketing offers in writing and do not enroll on the spot, especially if someone comes to your door.
- If you are interested in an alternative pricing plan (such as a variable rate), make sure that you read all of the fine print and that the lower rate is not just an introductory rate.
- Be wary of any offer that promises or guarantees savings.
- Always ask about any monthly fees or additional charges.
- **No alternative supplier is affiliated with or endorsed by your utility or the government.** If you sign up for service with an alternative supplier, you are entering a new contract with a different company.

To find out more information on energy suppliers in our area, please visit pluginillinois.org.



DOOR TO DOOR SOLICITORS

All persons seeking to solicit within our Village, other than religious or political organizations that are protected under the First Amendment, are required to apply for a Certificate of Registration with the Village. This does not include people who are exclusively distributing flyers. Although the Village registers solicitors it does not endorse or support the company or product being solicited.

Village Ordinance requires the individual to apply with the Village Clerk's Office prior to doing any door-to-door business in the Village. The Village reviews the application and conducts a background check of each individual. Upon approval, the applicant is issued a Solicitor Identification Card, which must be visibly displayed at all times while soliciting in the Village. Identification cards include a photo of the solicitor, their name and permit expiration date. Uninvited solicitors or suspicious individuals who cannot provide proof of solicitor registration should be



reported immediately by calling 9-1-1. Current registered solicitors can be viewed on the Village website and in the My Elk Grove Village app.

No solicitor, whether registered with the Village or not, is permitted to engage in "soliciting" prior to 9 a.m. or after 8 p.m. Monday through Saturday, or at any time on Sundays or on a state or national holidays.

Residents may display a "No Solicitor Invited" sign upon or near the main entrance door of their residence as notice to any solicitor that the occupant does not wish to interact with the solicitor. "NO SOLICITORS INVITED" decals are available at the Village Clerk's Office. Residents may contact the Village Clerk at 847-357-4040 for further information.



ELK GROVE 2025, CONT.

The map can be used to explore what infrastructure projects are planned in Elk Grove Village for the next eight years, and where they're happening.

Projects on the map have been organized into 6 categories: Facilities, Bicycle/Pedestrian, Major Road Projects, Street Resurfacing, Street Lights, and Aesthetics. Tabs along the top of the map can be used to navigate to different map features for more information about projects in each category.

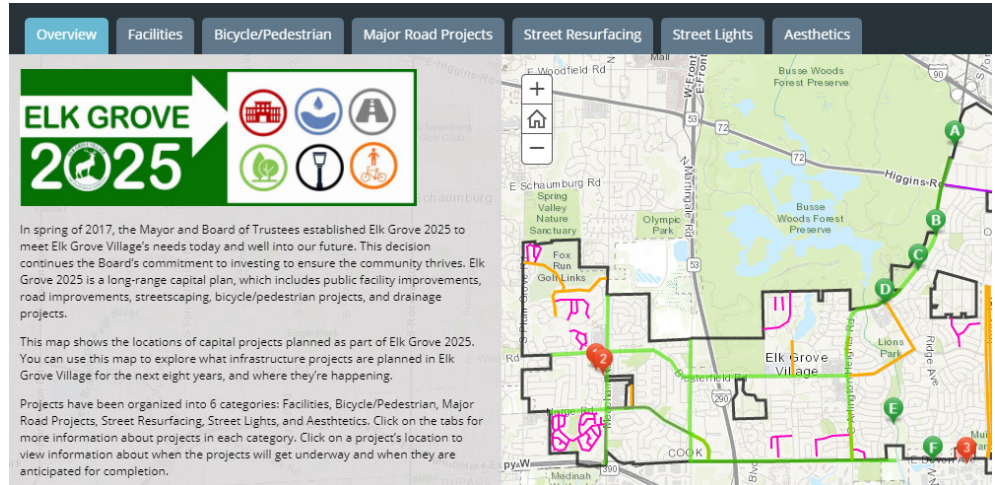

Clicking on a project's location will provide information about the anticipated project timeline.

More information on the background and funding of Elk Grove 2025, including the calculated impact on the average homeowner is also available on the Village website at www.elkgrove.org/2025.

UNDERSTANDING PROPERTY TAX RATES

Every year, local taxing bodies determine the amount of money needed to provide services to citizens—this is called a tax levy. In order to collect this money, the county must divide the property tax levy among all of the properties that make up each taxing body. The county uses the Equalized Assessed Value (EAV) of each property to determine what portion of the tax levy the property owner must pay.

$$\begin{array}{c}
 \text{\$ \$ \$} \\
 \text{Property Tax} \\
 \text{Levy}
 \end{array}
 \div
 \begin{array}{c}
 \text{Equalized} \\
 \text{Assessed Value of All} \\
 \text{Property in the Village}
 \end{array}
 =
 \begin{array}{c}
 0.964 \\
 \text{Tax Rate}
 \end{array}$$

EAV can change depending on market values and assessed values. Market values change based on actual property transactions, but assessed values can change based on successful property tax appeals, incentive-based property tax relief and property tax exemptions. Because the tax rate is calculated by dividing the Village's property tax levy by its total EAV, the tax rate can change from year to year, even if the Village keeps its property tax levy flat.

The Village has worked hard to keep its property tax levy stable and reduce the tax burden on its residents and businesses. The 2016 property tax levy (taxes payable in 2017) approved by the Village Board includes a slight decrease to the general fund levy. In order to collect that levy for the Village, Cook County divides the total EAV of all property in Elk Grove by the Village's tax levy to determine the Village's property tax rate. This tax rate is then multiplied by each property's EAV in order to determine the dollar amount owed to the Village.

Cook County must calculate this tax rate for all taxing districts in which you live. The total property tax rate on your bill is the sum of all the tax rates you will pay to all taxing districts where you live. Overall, the Village comprises approximately 10% of a typical resident's property tax bill, with 65-70% of the bill going toward school districts. The remainder of the property tax bill is made up by Cook County, townships and special taxing districts.

Residents and businesses in Elk Grove Village continue to experience the lowest combined property tax rate in northwest Cook County by an average of nearly \$1,131 lower compared to comparable communities for the most recent property tax bills.

TROUBLE WITH SKUNKS

Bordering the forest preserve, it is no surprise that we see so much wildlife activity near our homes. The Village's Environmental Health Division has recently received calls concerning skunk activity, which is higher than usual due to the recent mild winter. Skunks often become more active in the fall and are visible in the early morning and at dusk as the new adults venture out on their own to find new "territory". Skunks may burrow under buildings, sheds, decks or concrete stoops. They can raid garbage cans and dig holes in lawns in search of grubs.

Below are some tips on deterring skunks from your property:

- Do not leave out any food or water for animals, especially on the ground
- Secure garbage cans and close dumpster lids at night
- Control rodent and lawn grub populations
- Remove wood or brush piles
- Trim back bushes/vegetation overgrowth
- Seal openings under decks and sheds, cover window wells



Currently, there are no registered skunk repellents, but leaving on a radio, motion light, or strobe light near the burrow may deter skunks from your property. If you see a burrow hole under your deck or shed, do not seal it until you can ensure that all the skunks have exited. To check if the burrow is active, stuff the hole with newspaper or loose material to see if any of the material is pushed-out overnight. If you determine that you have skunks living on your property, the Health Division recommends working with a licensed wildlife removal company. Once the skunks are trapped and removed, the harborage hole can be secured with materials such as wire mesh, metal, wood, or concrete.

For more information regarding specific laws pertaining to skunk trapping reference the Illinois Department of Natural Resources website at www.dnr.illinois.gov or call the Village's Environmental Health Division at 847-357-4240 for a list of local wildlife control companies.

GET TO KNOW YOUR PROPERTY LINES

Knowing your property lines allows you to identify where to legally place structures such as fences, pools, sheds, garages and even compost piles. It can also assist in having good communication with your neighbors about where your property areas begin and end.

A plat of survey was provided to you at the time of purchase of your property. The plat of survey specifies the property corners and line measurements that separate your property from that of your neighbor's. It is important to store your survey in a safe and accessible location for your reference.

If you do not have survey, you may contact the Recorder of Deeds in your county to request a plat or hire a professional property surveyor to identify your property lines.

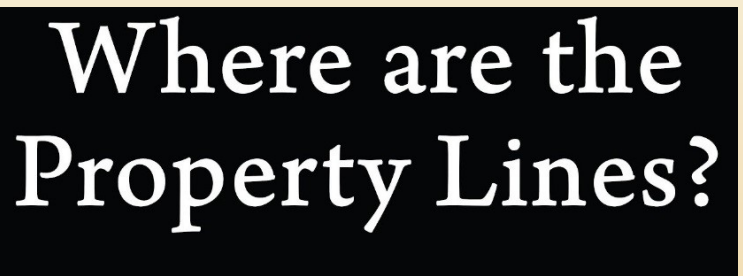



WINTER SNOW AND ICE CONTROL

Public Works stands ready to respond to this winter's freeze in a timely and expeditious manner. Our equipment has been prepared and salt supply has been secured. Residents and businesses play an important role in ensuring our streets are maintained in a clean and safe condition. We would like to thank everyone in advance for their cooperation, patience and understanding during the unpredictable winter season.



To help achieve a successful snow removal season please keep in mind these tips:

Parking Restrictions

When 2 or more inches of snow have fallen or are predicted to fall, do not park on any public street. Parked vehicles slow the progress of our snow removal fleet and often result in a section of roadway left unplowed. Parking is prohibited on both sides of a public street for 24 hours after the snowfall stops or until the clearing operation is complete.

Be Considerate of Pedestrians and Seniors

Residents and businesses are asked to shovel their sidewalks, clearing a path for pedestrians. In addition, please assist your neighbors who may be unable to clear their walks.

Plowed-In Driveway Aprons

 Snow removal equipment is designed to push snow to the parkway and unfortunately, pushing snow onto driveway aprons is unavoidable. Property owners can minimize the amount of snow pushed onto driveways by placing snow on their side of the sidewalk, as well as placing driveway apron snow in the parkway away from the flow of traffic to help our plows to push snow away from your driveway rather than onto it.

Do Not Push Snow Into Streets

 Driveways and sidewalks should be cleared by placing the snow on your property or adjacent parkway. Pushing snow into the street creates hazardous driving conditions and negates the effort of our snow operation. It is unlawful to move snow from driveways or private parking lots onto Village streets or the right-of-way.

Drive Cautiously

 Whenever practical, please stay off the roads during a heavy snowfall. If you must travel, drive slowly and cautiously. Please yield to snow removal equipment.

For more information on snow removal activities or to report a concern, please feel free to contact the Public Works Department at 847-734-8800 or visit www.elkgrove.org.

PLOWING & MAINTENANCE ON STATE & COUNTY ROADS

Please be aware that the Village does not maintain all the roadways within the Village limits. Cook County and the State of Illinois have the responsibility of plowing and maintaining the following roads:

Cook County

- Arlington Heights Road, south of Higgins
- Devon Avenue
- Landmeier Road, west of Higgins
- Meacham Road
- Nerge Road, west of Rohlwing
- Plum Grove Road

If you experience hazardous conditions on these roads, including any type of road damage, please call Cook County at 847-397-4145.

State of Illinois

- Arlington Heights Road, north of Higgins
- Biesterfield Road, Rohlwing to Martha
- Busse Road
- Elmhurst Road
- Higgins Road (Route 72)
- Rohlwing Road, south of Biesterfield



If you experience hazardous conditions on these roads, including any type of road damage, please call the State at 847-705-4171 or 847-705-4162.

DON'T VEER FOR DEER!

During mating season, deer will be more active and visible throughout the state. The risk for deer vs. vehicle crashes greatly increases in October, November and December, especially at dusk and dawn. Deer can dart in front of a vehicle in the blink of an eye. It's instinctual to swerve out of the way, but in doing so, drivers could lose control of the vehicle and cause a more severe crash. Follow these safe driving tips during mating season:

- Be aware of your surroundings and pay attention to deer crossing signs.
- Scan the sides of the road for eye shine – the reflection of headlights in the eyes.
- Prepare for the unexpected. Deer can stop in the road or double back.
- Slow down if you see deer. They travel in groups, so more deer are likely nearby.
- If a collision is inevitable, try to glance the vehicle off the deer and avoid swerving into the opposite lanes of traffic.



SIGNAGE NOT PERMITTED ON PUBLIC PROPERTY



The Village would like to remind residents not to tape signage on public property. We work hard to maintain a high standard of facilities, structures and equipment which enhance neighborhood aesthetics.

It may seem harmless to tape signage such as lost pet notices, garage sale signs, or real estate signs, but tape and other materials cause significant damage to painted poles. The picture to the left shows the damage to a street sign pole from a recently posted sign.

Signs are not permitted on Village parkways, medians, streetlights, traffic signals, Village-owned signs, or trees. Illegal signs will be confiscated and offenders may be responsible for repair or replacement costs and fines in accordance with the Village Code.



NOVEMBER 2017 ISSUE

ELK GROVE BusinessMatters



IN THIS ISSUE:

ENCLAVE is Open for Business

Industrial Vacancy Rate Continues to Reach Historic Lows

2017 Business Excellence Awards

Village Hosts Business Leaders Forum

Strictly Business Podcast

Illinois Route 390 Tollway Now Complete

ENCLAVE IS OPEN FOR BUSINESS!

On Thursday, October 12, Village officials joined founders, colleagues and supporters, for the Grand Opening Ribbon-Cutting of ENCLAVE for Entrepreneurs O'Hare.

ENCLAVE is a not-for-profit economic development education initiative which



offers many different programs and initiatives of ENCLAVE O'Hare, including: Master classes, seminars, panel discussions, workshops, focus groups, funding pitches, product/service showcases, video talks, weekend retreats and networking gatherings. Additionally, work spaces, meeting places, and other accommodations are available in ENCLAVE O'Hare's 15,000+ square-foot, three-level headquarters building at 75 Turner Avenue.

ENCLAVE

Entrepreneurs | Learning & Earning

Visit the ENCLAVE website at www.enclaveforentrepreneurs.com to find out more about this a local-to-global earning and learning center for the world's entrepreneurs and their influencers.

This newsletter is published by the Village of Elk Grove Village 901 Wellington Avenue Elk Grove Village, IL 60007 Telephone 847.439.3900 TDD 847.357.4088 www.elkgrove.org

The Village Hall is open 8:30 a.m. to 5:00 p.m. Monday through Friday for payment of water bills, local fines, vehicle stickers and general Village information. In addition, the Finance counter is open on the first Saturday of each month from 9:00 a.m. to noon, and the Community Development counter is open on the first Saturday of the month of May through September from 9:00 a.m. to noon.

Village Board meetings are generally held on the second and fourth Tuesday of the month at 7:00 p.m.

ELK GROVE VILLAGE INDUSTRIAL VACANCY RATE CONTINUES TO REACH HISTORIC LOWS

Colliers International recently released its 2017 third quarter industrial vacancy report for the O'Hare Industrial Market. Colliers reported that Elk Grove Village's current vacancy rate is 3.17%, a historic low for the Village.

The Village's vacancy rate has continued to drop, and is down from 5.47% at the end of 2015. A vacancy rate of 5% is considered essentially full, taking into account natural vacancies for businesses that are moving in and out of properties.

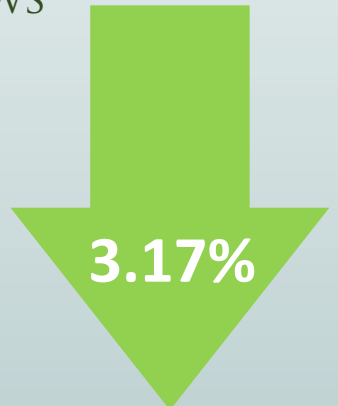

GOVERNOR ATTENDS MADE IN ELK GROVE EXPO, RECOGNIZES VILLAGE AS PRO-GROWTH ROLE MODEL

The fifth annual Made in Elk Grove Manufacturing & Technology Expo was held on October 17, 2017. This event is hosted by Elk Grove Village to promote its vast industrial business community. Among the visitors was Illinois Governor Bruce Rauner, who made a special visit to speak with participating Elk Grove based manufacturers.

Rauner spoke of the manufacturing industry as the backbone of Illinois' prosperity and recognized Elk Grove Village for being pro-growth, calling the Village the best run community in Illinois and a great place to do business. Governor Rauner noted that he uses Elk Grove Village as a role model to inspire other communities to remove restrictions and reduce red tape to create a positive business environment.

Elk Grove Village Mayor Craig Johnson was glad of the opportunity to show Governor Rauner this unique event, which the Village hosts at no cost to attendees or exhibitors. This is the fifth year the Village has hosted the Expo, which provides Elk Grove-based manufacturers an opportunity to network with each other and connect with attending manufacturers from around the Midwest.



2017 BUSINESS EXCELLENCE AWARD WINNERS

At the 2017 Made in Elk Grove Manufacturing & Technology Expo held on October 17, the Village presented three local manufacturing companies with Business Excellence Awards based on their commitment to environmental consciousness, innovative manufacturing practices and the community. Governor Bruce Rauner joined Mayor Johnson in presenting the 2017 Business Excellence Awards during a luncheon held for the exhibitors.



Excellence in Sustainability: Chem Plate Industries, 1800 Touhy Avenue

Chem-Plate is an integrated heat treating, plating, and sorting company, which has invested in new technology that meets the highest international standards for zero waste and is environmental friendly. Their technology has received an award from the Environmental Protection Agency for most valuable pollution prevention technology. Martin Straus, CEO of Chem Plate Industries, accepted the award on behalf of the company.

Excellence in Innovation: Jarvis Lighting, 1950 Estes Avenue

Jarvis Lighting is a leading manufacturer of LED commercial lighting. Despite much of LED lighting manufacturing taking place overseas, Jarvis has implemented lean manufacturing to keep production here in Elk Grove Village. Investment into and inclusion of all employees' ideas along with continuous improvement has kept Jarvis both profitable AND local. Kirby Corkill, President of Jarvis Lighting accepted the award on behalf of the company.

Excellence in Community Support: eWorks Electronic Services, 1201 Estes Street

eWorks Electronic Services is a not-for-profit with the mission of creating employment opportunities for people with developmental challenges and disabilities. eWorks achieves this mission by providing competitive recycling, refurbishment and resale services of all types of office and industrial technologies and consumer electronics. Lou Fyda and Randy Densberger of eWorks accepted the award on behalf of the company.



2017 INDUSTRIAL DEVELOPMENT OF THE YEAR

MC Machinery received the Village's 2017 Industrial Development of the Year award for their new North American Headquarters at 85 Northwest Point Boulevard. Governor Bruce Rauner joined Mayor Johnson in presenting this award at the 2017 Made in Elk Grove Manufacturing & Technology Expo. Lou Clifford and David Alice of MC Machinery accepted the award on behalf of the company.

MC Machinery, the machine building division of the Japan based Mitsubishi Corporation, constructed a state-of-the-art 124,000 square foot Midwest headquarters, corporate office and showroom visible from Interstate I-90 and employing 200 employees. They broke ground on the development in the summer of 2016 and were open for business by the summer of 2017.



LOCAL BUSINESS RECYCLES ELECTRONICS & PROVIDES JOBS FOR PEOPLE WITH DISABILITIES

On Friday, September 8, Village Trustees Jim Petri and Sam Lissner, along with Director of Business Development Josh Grodzin, conducted a Business Ambassador meeting at eWorks located at 1201 Estes Ave.

Jeff Stagg, Lou Fyda and Randy Densberger of eWorks showed the Village representatives around their facility and explained that eWorks is a 501(c)(3) "not for profit" organization which was established in 2009 to create employment opportunities for people with disabilities. eWorks does this by offering recycling, refurbishment and resale services for office and industrial technologies and consumer electronics.



eWorks is located at 1201 Estes Street and accepts a variety of electronics free of charge, including computers, printers, cable boxes, DVD players, printer cartridges and more. Monitors and televisions are accepted for a small fee. Appliances are not accepted.

Residents can drop off electronics Monday - Friday, from 9am - 3pm and for more information can contact 1-855-213-8348 or info@eworksesi.org. Businesses need to reach out prior to drop off and for more information can contact rdensberger@eworksesi.org or 331-207-4343.

STRICTLY BUSINESS PODCAST

The Strictly Business Podcast explores the business community in Elk Grove Village through interviews with business owners and industry experts. Episodes focus on themes including business profiles, workforce development, innovation, leadership, culture, entrepreneurship, infrastructure, regional economics, and others. Topics are discussed in a lively conversational style with industry experts, business owners, and public sector leaders.

Episodes of the podcast are available for download at www.egvbizhub.com, or from the Apple iTunes store (search Elk Grove Village). If you have comments or feedback on the podcast, please email us at strictlybizpodcast@gmail.com.

ILLINOIS ROUTE 390 TOLLWAY NOW COMPLETE

On November 1, 2017, the eastern segment of Route 390 between I-290 and Illinois Route 83 was opened to traffic with all-electronic tolling. This segment completes the Illinois Route 390 Tollway Project, with three lanes in each direction between I-290 and Illinois Route 83, as well as four interchanges and three mainline collection points.

The new Illinois Route 390 is the first all-electronic roadway to open on the Illinois Tollway system. Route 390 features 30 bridges, the system-to-system interchange at I-290 and Illinois Route 390 and a reconstructed Rohlwing Road (Illinois Route 53) Interchange. New interchanges and local road improvements have been constructed at Park Boulevard, Arlington Heights Road, Prospect Avenue, Mittel Drive, Wood Dale Road, Lively Boulevard and Illinois Route 83. More than 13 lane miles of frontage roads have also been constructed to accommodate local traffic.

Toll Rates

The Illinois Route 390 Tollway will open on November 1, 2017. With no coin baskets or booths on the roadway, I-PASS transponders in every vehicle will easily collect tolls along the roadway. Unpaid tolls can be paid online or by mail.

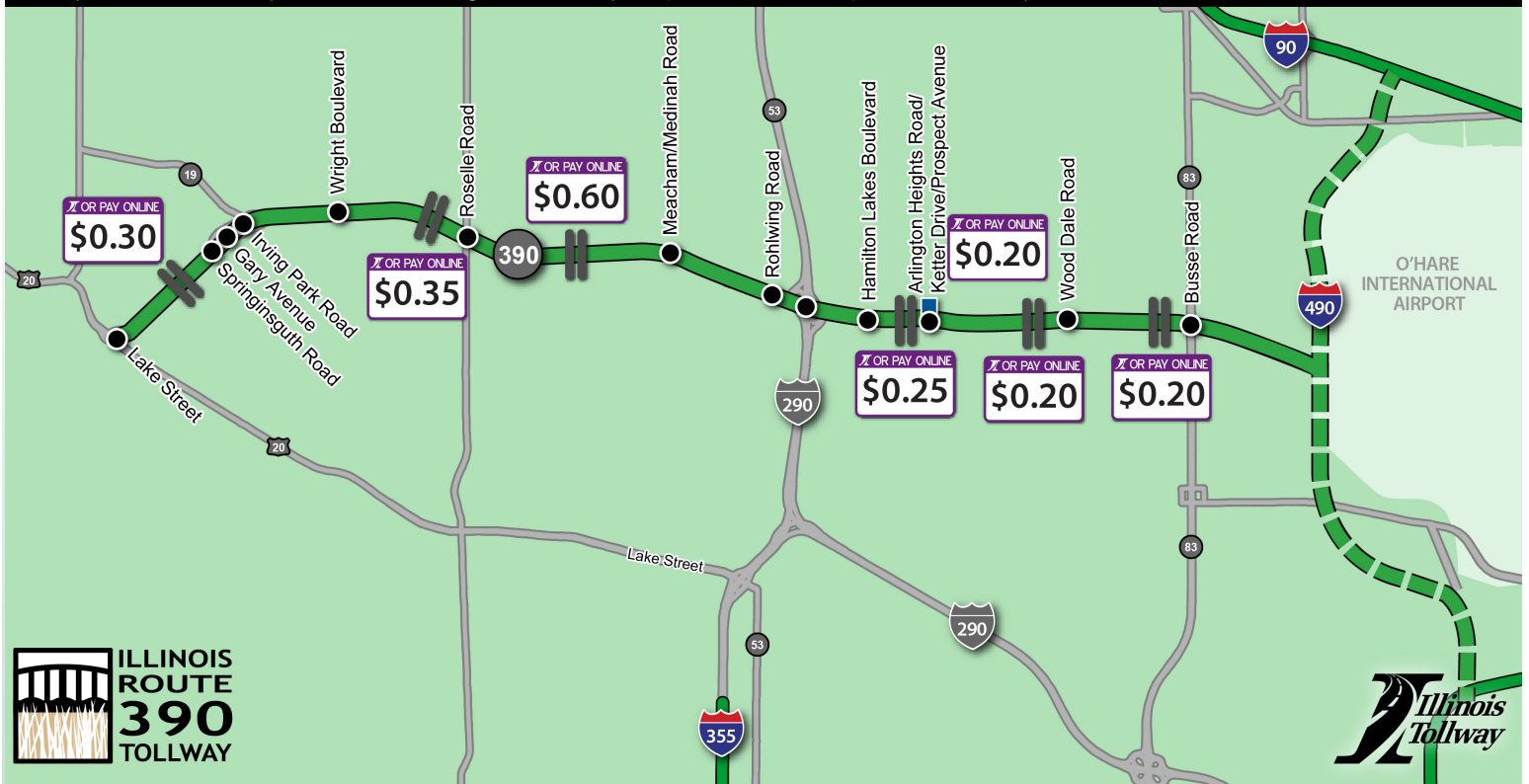

- Access Point
- Cashless Tolling Location - Mainline
- Cashless Tolling Location - Ramp

The next phase of construction for the Elgin O’Hare western access project will be on I-490, connecting Route 390 on the west side of the airport linking to the Tri-State Tollway in Franklin Park and the Jane Addams Tollway in Des Plaines. Sections of I-490 are currently in the design phase, with overall completion currently planned for 2025.